

5/9/2025 EC\POLK29-EC-EC1.TSH.dgn
R:\H\2025\EC\POLK29-EC-EC1.TSH.dgn

PROJECT: 41665.3D

See Sheet 1-A For Index of Sheets
See Sheet 1-B For Symbology

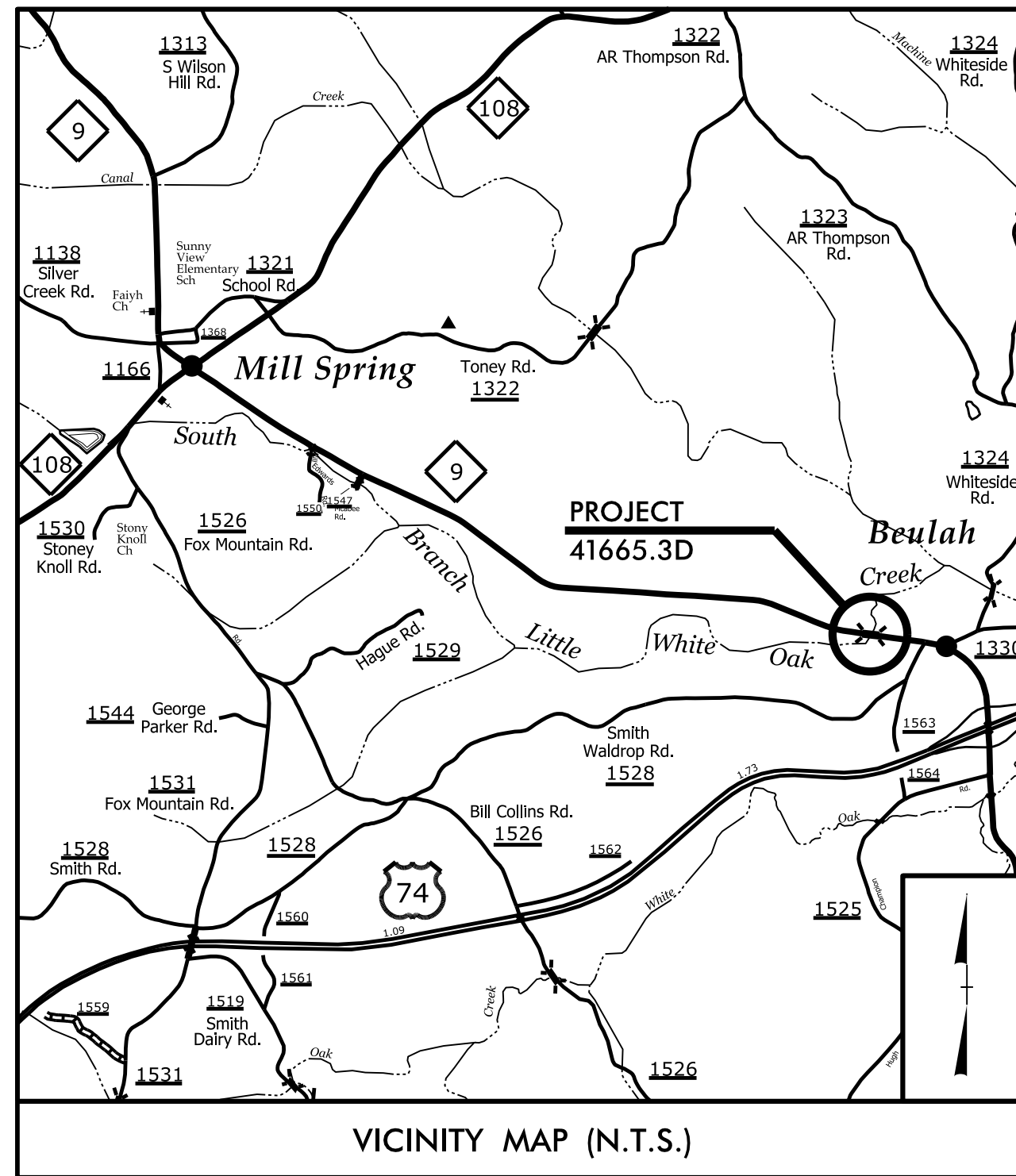

STATE OF NORTH CAROLINA
DIVISION OF HIGHWAYS
PLAN FOR PROPOSED
HIGHWAY EROSION CONTROL
POLK COUNTY

LOCATION: BRIDGE #29 OVER SOUTH BRANCH
LITTLE WHITE OAK CREEK ON NC 9
TYPE OF WORK: GRADING, DRAINAGE, PAVING, AND STRUCTURE

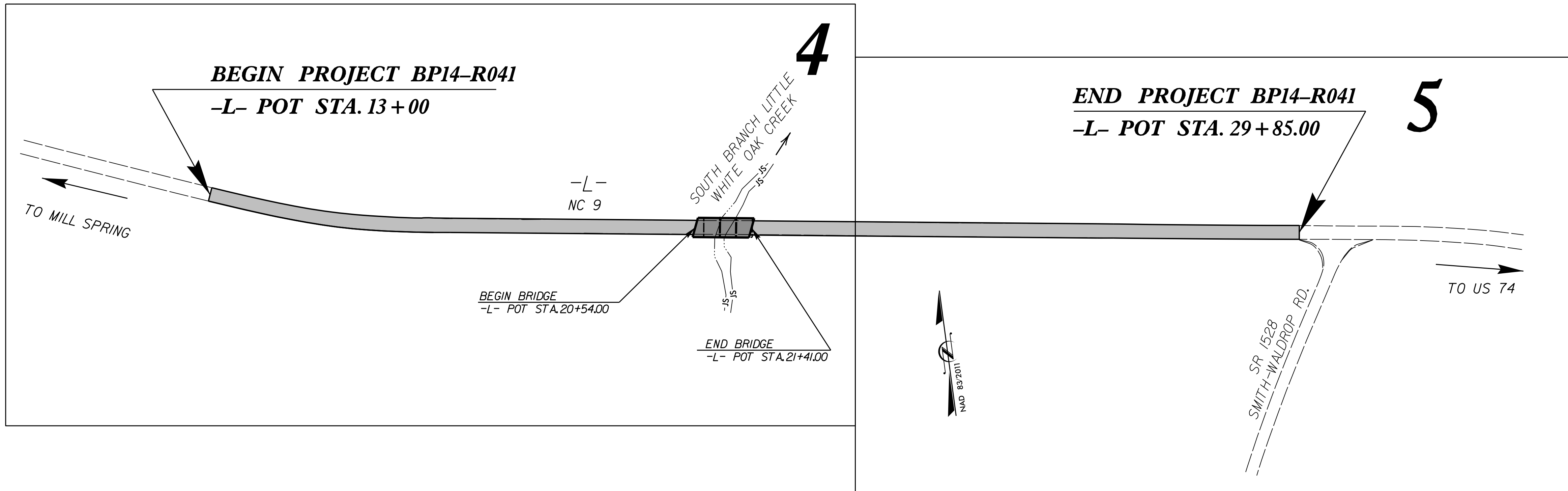

THIS PROJECT CONTAINS
EROSION CONTROL PLANS
FOR CLEARING AND
GRUBBING PHASE OF
CONSTRUCTION.

KEVIN S. HUTCHENS, PE
LEVEL III NAME
3635
LEVEL III CERTIFICATION NO.

GRAPHIC SCALE

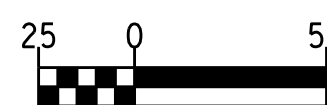

PLANS

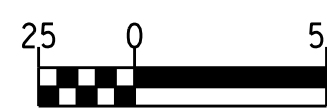

PROFILE (HORIZONTAL)

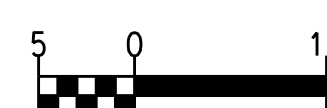

PROFILE (VERTICAL)

ROADSIDE ENVIRONMENTAL UNIT
DIVISION OF HIGHWAYS
STATE OF NORTH CAROLINA

THESE EROSION AND SEDIMENT CONTROL PLANS COMPLY
WITH THE REGULATIONS SET FORTH BY THE NCG 010000
GENERAL STORMWATER CONSTRUCTION PERMIT ISSUED BY THE NORTH
CAROLINA DEPARTMENT OF ENVIRONMENTAL QUALITY DIVISION
OF ENERGY, MINERAL, AND LAND RESOURCES

Prepared in the Office of:
Weston & Sampson
2052 Energy Drive
Apex, NC 27502
Phone: 919.297.0220
NC License: C-4847
for
NCDOT DIVISION 14
NCDOT CONTACT: ZACHARY T. SHULER, PE
DIVISION 14 BRIDGE PROGRAM MANAGER
(828) 488-0902

2024 STANDARD SPECIFICATIONS

Roadway Standard Drawings

The following roadway english standards as appear in "Roadway Standard Drawings"- Roadway Design Unit - N. C. Department of Transportation - Raleigh, N. C., dated January 2024 and the latest revision thereto are applicable to this project and by reference hereby are considered a part of these plans.

1604.01	Railroad Erosion Control Detail	1632.01	Rock Inlet Sediment Trap Type A
1605.01	Temporary Silt Fence	1632.02	Rock Inlet Sediment Trap Type B
1606.01	Special Sediment Control Fence	1632.03	Rock Inlet Sediment Trap Type C
1607.01	Gravel Construction Entrance	1633.01	Temporary Rock Silt Check Type A
1622.01	Temporary Berms and Slope Drains	1633.02	Temporary Rock Silt Check Type B
1630.01	Riser Basin	1634.01	Temporary Rock Sediment Dam Type A
1630.02	Silt Basin Type B	1634.02	Temporary Rock Sediment Dam Type B
1630.03	Temporary Silt Ditch	1635.01	Rock Pipe Inlet Sediment Trap Type A
1630.04	Stilling Basin	1635.02	Rock Pipe Inlet Sediment Trap Type B
1630.05	Temporary Diversion	1640.01	Coir Fiber Baffle
1630.06	Special Stilling Basin	1645.01	Temporary Stream Crossing
1631.01	Matting Installation		